

Joseph Baldrige claim

C 178-109
John Chain

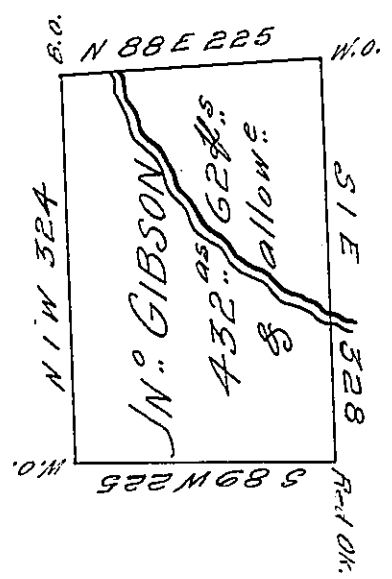

011-851-0
Robert Chain

Chas Campbell

In consequence of an Improvement Said to be Began May 11th 1795 There was Survey^d for John Gibson the above Described Tract of Land Containing Four Hundred and thirty two acres and 62 P^{ar}ches with an allowance Proportioned to Six per Ct. Situate in District N^o: 5 in Allegheny County Survey^d Dec^r: 1st 1795.

J. John Moore D. S.

Daniel Brodhead Esq^r.
Surv^t: Gen^l: of Pennsylvania }

IN TESTIMONY that the above is a copy of the original remaining on file in the Department of Internal Affairs of Pennsylvania, made conformably to an Act of Assembly approved the 16th day of February, 1833, I have hereunto set my Hand and caused the Seal of said Department to be affixed at Harrisburg, this twenty-second day of August 1906

Leach D. Brown
Secretary of Internal Affairs.